

V-Force Wiring Pin Outs**Part #** **68024,** **68025,** **68026****DODGE**

<u>Year</u>	<u>Model</u>	<u>Engine</u>	<u>TPS Wire Color</u>	<u>TPS Wire Location</u>	<u>MAP Wire Color</u>	<u>MAP Location</u>
1996-2001	AVENGER	2.0L	BRN/RED	1	YEL/BLK	A
1996-2001	AVENGER	2.5L	BRN/RED	1	YEL/BLK	A
2007-2012	CALIBER	2.0L	ORG/BRN	1	VIO/BLU	A
1998-99	INTREPED	2.7L	ORG/DKBL	1	DKGRN/RED	A
2000-2005	INTREPED	2.7L	ORG/DKBL	1	DKGRN/RED	A
1996-97	INTREPED	3.3L	ORG/DKBL	1	DKGRN/RED	B
1998-2001	INTREPED	3.2L	ORG/DKBL	1	DKGRN/RED	A
1996-2005	INTREPED	3.5L	ORG/DKBL	1	DKGRN/RED	B
2010-2012	JOURNEY	2.4L	BRWN/ORG	1	VIO/BRWN	F
2012	JOURNEY	2.7L	BROWN	1	VIO/DKGRN	K
2010-2012	JOURNEY	3.6L	BRWN/ORG	1	VIO/BRWN	K
1996-99	NEON	2.0-Y	ORG/DKBL	1	DKGRN/RED	96-97=C 98-99=D
1996-99	NEON	2.0-C	ORG/DKBL	1	DKGRN/RED	96-97=C 98-99=D
2000-2005	NEON	2	ORG/DKBL	1	DKGRN/RED	D
1996-98	STRATUS	2.0L	ORG/LTBLU	1	DKGRN/RED	96=E 97-98=D
1999-2001	STRATUS	2.0L	ORG/DKBL	1	DKGRN/RED	D
1996-98	STRATUS	2.4L	ORG/LTBLU	1	DKGRN/RED	96=E 97-98=D
1999-2003	STRATUS	2.4L	ORG/DKBL	1	DKGRN/RED	D
1996-98	STRATUS	2.5L	ORG/LTBLU	1	DKGRN/RED	96-97=E 98=D
1999-2001	STRATUS	2.5L	ORG/DKBL	1	DKGRN/RED	F
2002-2005	STRATUS	3.0L	YELLOW	1	BLU/RED	D
2004-2005	STRATUS	2.4L	YELLOW	1	BLU/RED	D
2006	STRATUS	2.4L	ORG/BLK	1	DKGRN/RED	C
2006	STRATUS	2.7L	ORG/BLK	1	DKGRN/RED	D

CHRYSLER

<u>Year</u>	<u>Model</u>	<u>Engine</u>	<u>TPS Wire Color</u>	<u>TPS Wire Location</u>	<u>MAP Wire Color</u>	<u>MAP Location</u>
2011-2012	200	2.0L	BRWN/ORG	1	VIO/BRWN	F
2011-2012	200	2.4L	BRWN/ORG	1	VIO/BRWN	F
2011-2012	200	3.6	BRWN/ORG	1	VIO/BRWN	I
1999	300M	3.2,5L	ORG/DKBL	1	DKGRN/RED	A
2000-2004	300M	3.2,5L	ORG/DKBL	1	DKGRN/RED	A
2005	300M	2.7,3.5L	BRWN/ORG	1	VIO/BRWN	A
1996-1999	CIRRUS	2.4L	ORG/LTBL	1	DKGRN/RED	C
1996-1999	CIRRUS	2.5L	ORG/LTBL	1	DKGRN/RED	D
2000-2003	CIRRUS	2.4L	ORG/LTBL	1	DKGRN/RED	C
2000-2003	CIRRUS	2.5L	ORG/LTBL	1	DKGRN/RED	D
1996	CONCORDE	3.3L	ORG/LTBL	1	TAN/YEL	B
1996-1997	CONCORDE	3.5L	ORG/DKBL	1	DKGRN/RED	B

CHRYSLER

				TPS Wire	MAP Wire	MAP
1998-1999	CONCORDE	3.5L	ORG/DKBL	1	DKGRN/RED	A
1998-2003	CONCORDE	2.7L	ORG/DKBL	1	DKGRN/RED	A
1998-2003	CONCORDE	3.2L	ORG/DKBL	1	DKGRN/RED	A
2000-2003	CONCORDE	3.5L	ORG/DKBL	1	DKGRN/RED	A
1999-2003	LHS	2.7L	ORG/DKBL	1	DKGRN/RED	A
1999-2003	LHS	3.2L	ORG/DKBL	1	DKGRN/RED	A
1999-2003	LHS	3.5L	ORG/DKBL	1	DKGRN/RED	A
2004-2007	PACIFICA	3.5L/3.8L	BRN/ORG	1	PPL/DKBRN	H
1999-2002	PT-CRUISER	2.4L	ORG/LTBL	1	DKGRN/RED	A
1996-1999	SEBRING(1)	2.4L	ORG/LTBL	1	DKGRN/RED	A
1996-1997	SEBRING(1)	2.5L	ORG/LTBL	1	DKGRN/RED	A
1998-1999	SEBRING(1)	2.5L	ORG/DKBL	1	DKGRN/RED	A
2000-2003	SEBRING(1)	2.4L	ORG/LTBL	1	DKGRN/RED	C
2000-2003	SEBRING(1)	2.5L	ORG/DKBL	1	DKGRN/RED	C
1996-1999	SEBRING(2)	2.0L	BRN/RED	1	DKGRN/RED	A
1996-1999	SEBRING(2)	2.5L	BRN/RED	1	DKGRN/RED	A
2000-2003	SEBRING(2)	2.0L	BRN/RED	1	DKGRN/RED	C
2000-2003	SEBRING(2)	2.5L	BRN/RED	1	DKGRN/RED	C
2004-2006	SEBRING(1)	2.4L	ORG/DKBLU	1	DKGRN/RED	C
2004-2006	SEBRING(1)	2.7L	ORG/DKBLU	1	DKGRN/RED	D
2004-2005	SEBRING(2)	2.4L/3.0L	YELLOW	1	BLU/RED	C
2004-2006	SEBRING(3)	2.4L	ORG/DKBLU	1	DKGRN/RED	C
2004-2006	SEBRING(3)	2.7L	ORG/DKBLU	1	DKGRN/RED	D
2007	SEBRING	2.4L	BRN/ORG	1	DKBLU/LTBLU	F
2007	SEBRING	2.7L	BRN/ORG	1	PPL/DKGRN	G

TPS LOCATION:

1 = ON SIDE OF THROTTLE BODY, OPPOSITE THROTTLE LINKAGE

MAP LOCATION:

A = ON LEFT SIDE OF INTAKE MANIFOLD

B = ON UPPER INTAKE PLENUM

C = ON INTAKE MANIFOLD PLENUM

D = ON RIGHT FRON OF INTAKE PLENUM

E = ON INTAKE MANIFOLD PLENUM, NEAR TIMING BELT COVER

F = LEFT FRONT OF ENGINE

G = TOP RIGHT REAR OF ENGINE

H = TOP FRONT OF ENGINE

I = TOP REAR OF ENGINE

J= ON REAR OF INTAKE MANIFOLD

K = ON FRONT OF INTAKE MANIFOLD

L = ON THROTTLE BODY



AP020 Disc
(Ø 90 mm)

AP013 Disc
(Ø 80 mm)

AP036 Disc
(Ø 70 mm)

Package Contents:
(1) Self-adhesive dash or console pedestal mounting disc
(1) Alcohol cleaning pad

No Tools Required for installation.

***Note:** Adhesive disc is intended for semi-permanent installation and one time application. If disc needs to be removed, please see the removal instructions below.

Dash or Console Mounting Instructions

Step 1. Choose a suitable location for disc (and pedestal) installation. Do not place mount in or near an air bag deployment zone or where it will obstruct view of the road or hinder vehicle operation.

Step 2. Clean the dash or console surface area thoroughly with the included alcohol pad. Allow the area dry before applying the mounting disc.

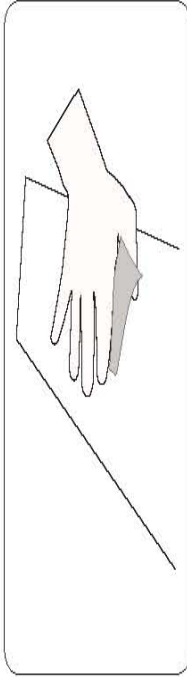

Step 3. Remove the paper backing of the disc and place on the cleaned surface. Press the top of the disc down firmly to allow the adhesive to stick to the surface. Allow 24 hours for the adhesive to cure to the surface before applying any pressure.

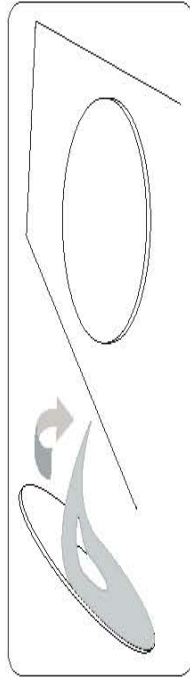

Step 4. Place the suction cup of the pedestal (sold separately) firmly down on the center of the mounting disc and lower the securing lever.

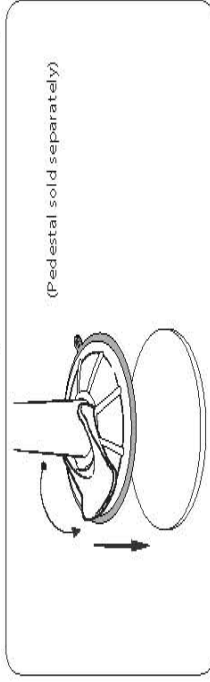

Disc Removal Instructions

Step 1. Prepare the surface around the disc by applying a generous amount of rubbing alcohol or similar adhesive removal product to the area with a cotton swab. Let the liquid saturate the adhesive area for about a minute.

Step 2. Take a long piece of dental floss in each hand and slowly work back and forth at the base of the adhesive disc. Gently use the dental floss to cut the adhesive from the dash or console until the black plastic disc is removed.

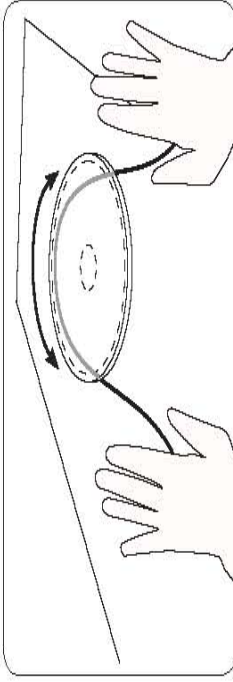

Step 3. If the sticky adhesive area breaks apart or does not come off completely, re-apply a small amount of alcohol (or adhesive removal liquid) and carefully lift off the remaining area by hand.



Safety Precautions

Follow all manufacturer safety guidelines for operating your device. Failure to practice safe usage of GPS device while driving may result in damage, injury, or death. Do not install Arkon products over an air bag cover or within the air bag deployment zone. Arkon is not responsible for any damages caused to your car, your device, or yourself due to the installation or use of this pedestal mount.



The Mobile Mounting Specialists™

Consumer Hotline:
USA (800) 841-0884
INT'L (626) 254-9005
Monday - Friday 9 am - 5 pm, PST

www.arkon.com
Arcadia, CA 91706 USA
Designed in USA | Made in Taiwan
© Copyright 2009 Arkon Resources, Inc.





GN014-SBH
Windshield Mount with
Swivel Ball Head Assembly

Patent Pending

Windshield Mounting

- Step 1.** Find a safe location on the interior of the vehicle's windshield to mount the pedestal. Firmly push the suction base (A) against the windshield and flip the base lever down (B) to the locked position. See diagram below.
- Step 2.** Adjust the angle of the pedestal arm by tightening the angle adjustment knob (C) at the base to the desired angle.

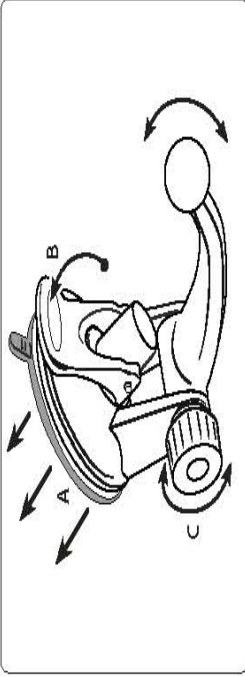

Swivel Ball Head Assembly Attachment

- Step 1.** Slip the tightening ring (D) over the pedestal ball. Snap the dual-T head adapter plate (E) on to the pedestal ball (F). Screw the tightening ring over the adapter plate until securely holding the plate. Adjust the angle as needed.

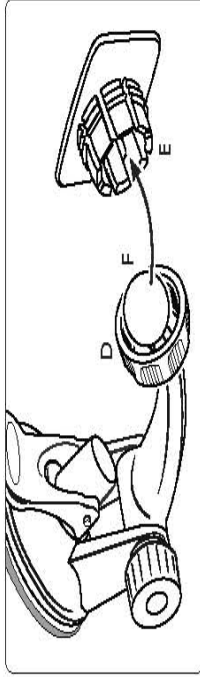

Safety Precautions
Follow all manufacturer safety guidelines for operating your device. Failure to practice safe usage of GPS device while driving may result in damage, injury, or death. Arkon is not responsible for any damages caused to your car, your device, or yourself due to the installation or use of this pedestal mount.

Range Swivels

- (I) GN014 - Mini windshield mount
(J) Swivel ball head assembly with dual T-tab pattern adapter plate and tightening ring.

Compatible with:

- All Arkon dual T-tab pattern phone cradles and adapter plates
- Most Garmin 17mm ball connections. (See website for full list)

! Do not place mount in or near an air bag deployment zone or where it will obstruct view of the road.

Attach Cradle or Device to Pedestal

- Step 1.** To attach your cradle or device (not included, sold separately) to the dual T-head, insert the dual T-tabs (G) into the dual T-slots (H) on the back of the cradle or device.

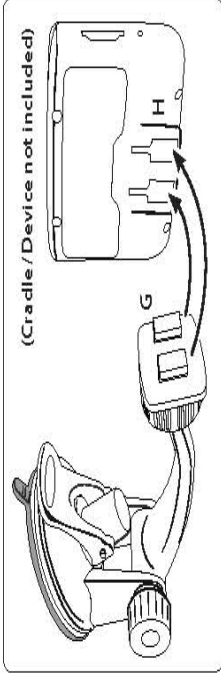

Attaching a Garmin Device to Pedestal

- Step 1.** Do not attach the swivel ball head assembly. Attach your Garmin device (not included, sold separately) to the ball head by firmly inserting the ball head (I) into the cavity (J) in the back of the device.

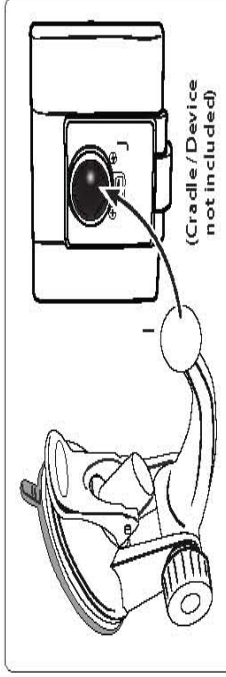

All brand names and product names are trademarks of their respective owners.

ARKON[®]
RESOURCES INC.

The Mobile Mounting Specialists™

Consumer Hotline: www.arkon.com
USA (800) 841-0884 Arcadia, CA 91006 USA
INT'L (626) 254-9005 Designed in USA | Made in China and Taiwan
 Monday - Friday 9am - 5pm, PST © Copyright 2009 Arkon Resources, Inc.