

JET Performance V-Force Wiring Pin Outs

ACURA

<u>Year</u>	<u>Model</u>	<u>Engine</u>	<u>Color</u>	<u>TPS Location</u>	<u>MAP Wire Color</u>	<u>MAP Location</u>
1997-2003	CL	ALL	RED/BLK	1	RED/GRN	B
1988-1993	INTEGRA	ALL	RED/BLU	1	WHITE	A
1994-2001	INTEGRA	1.8L	RED/BLK	1	WHT/YEL	B
1988	LEGEND	ALL	RED/YEL	1	RED	E
1989	LEGEND	ALL	RED/YEL	1	GRN/WHT	E
1990	LEGEND	ALL	RED/YEL	1	YEL/WHT	E
1991-1992	LEGEND	ALL	RED/BLU	1	RED	E
1993	LEGEND	ALL	RED/BLU	1	RED	E
1994-1995	LEGEND	ALL	RED/BLU	1	RED	E
2001-2002	MDX	ALL	RED/BLK	1	LT GRN/RED	B
2003-2006	MDX	ALL	GRN/YEL	1	GRN/RED	I
2007-2012	MDX	3.7L	RED/BLK	1	GRN/RED	B
1996-1999	RL	3.5L	RED/BLK	1	RED/GRN	F
2000	RL	3.5L	RED/BLK	1	RED/GRN	I
2001-2008	RL	3.5L,3.7L	RED/BLK	1	RED/GRN	I
2009-2012	RL	3.7L	RED	1	LT. GREEN	I
2002-2006	RSX	ALL	RED/BLK	1	GRN/RED	B
1996-1998	TL	3.2L	RED/BLK	1	WHT/YEL	G
1999	TL	3.2L	RED/BLK	1	RED/GRN	B
2000	TL	3.2L	RED/BLK	1	RED/GRN	B
2001-2007	TL	3.2L	RED/BLK	1	GRN/RED	B
2007-2012	TL	3.5L,3.7L	RED/BLK	1	GRN/RED	I
2004-2005	TSX	ALL	RED/BLK	1	GRN/RED	B
2006-2007	TSX	ALL	RED/YEL	2	GRN/RED	I
2008-2012	TSX	ALL	RED/BLK	1	GRN/RED	I
2010-2012	ZDX	ALL	RED/BLK	1	GRN/RED	I
1992-1994	VIGOR	ALL	RED/YEL	1	WHT/BLU	C

CONTINUED NEXT PAGE

MAP LOCATIONS

- A = Mounted to the center of the firewall
- B = Mounted on the top of the throttle body housing
- C = Mounted on the drivers side shock tower
- D = Mounted on the passenger side shock tower
- E = Mounted inside the emission control box on the firewall
- F = Mounted on the passenger side of the engine, on the fuel rail
- G = Mounted on the passengers side of the firewall in the emission control box
- H = Mounted on the drivers side top of engine
- I = Mounted on the passengers side of engine, on the intake manifold
- J = Mounted on passengers side floorboard near computer
- K = Mounted on top of engine, in the center
- L = Mounted on top of the engine, on the air intake assembly
- M = Mounted on the left side of the intake manifold near throttle body
- N = Mounted on the left side of the engine
- O = Mounted on rear of Intake manifold

TPS LOCATIONS

- 1 = The TPS (throttle position sensor) is located on the throttle body on the opposite side of the throttle shaft linkage
- 2 = The APP (accelerator pedal position sensor) is located on the right hand side of the engine compartment, it has cable going to a plastic housing and the sensor is mounted to the housing.

NOTE: FOR OPTIONAL 02 SENSOR WIRING SEE CHART ON PAGE 29

AUDI

<u>Year</u>	<u>Model</u>	<u>Engine</u>	<u>TPS Wire Color</u>	<u>TPS Location</u>	<u>MAF Wire Color</u>	<u>MAF Location</u>	<u>Footnotes</u>
1997-1999	A4	1.8 L	WHT/YEL	1	GREEN	A	(**)
2000-2003	A4	1.8 L	BRWN/GRN	1	GREEN	B	(**)
2004-2005	A4	1.8 L	BROWN	2	GREEN	C	(**)
2006	A4	1.8 TURBO	BROWN	2	GREEN	C	(**)
2006	A4	2.0 TURBO	BROWN	2	GREEN	C	(**)
2007-2009	A4	2.0 TURBO	BROWN	2	GRN/GREY	C	(**)
2010-2012	A4	2.0 TURBO	BROWN	2	BRWN/BLU	A	(**)
1996	A4	2.8 L	BLUE/BRWN	1	GREEN	A	(**)
1997-1999	A4	2.8 L	WHT/YEL	1	GREEN	A	(**)
2000-2001	A4	2.8 L	BRWN/GRN	1	GREEN	B	(**)
2002-2005	A4	3.0 L	BROWN	2	GREEN	B	(**)
2006	A4	3.0 L	BROWN	2	GREEN	C	(**)
1996-1997	A6	2.8 L	BLUE/BRWN	1	GREEN	A	(**)
1998-1999	A6	2.8 L	WHT/YEL	1	GREEN	A	(**)
2000-2004	A6	2.7 TURBO	BRN/GRN	2	GREEN	B	(**)
2000-2001	A6	2.8 L	YEL/BLU	2	GREEN	B	(**)
2002-2004	A6	3.0 L	YEL/BLU	2	GREEN	B	(**)
2000-2004	A6	4.2 L	YEL/BLU	2	GREEN	B	(**)
2005-2006	A6	4.2 L	YEL/BLU	2	GRN/RED	B	(**)
2007-2012	A6	4.2 L	YEL/BLU	2	GRN/VIOLET	B	(**)
2000-2002	S4	2.7 TURBO	YEL/BLU	2	GREEN	D	(**)
2004-2009	S4	4.2 L	YEL/BLU	2	GREEN	E	(**)
2002-2003	S6	4.2 L	YEL/BLU	2	GREEN	A	(**)
2000-2006	TT	1.8 L	GRY/BLU	2	GREEN	A	(**)

CONTINUED NEXT PAGE

Footnotes

() = You are connecting to the Mass Air Flow Sensor**

TPS LOCATION:

1 = ON SIDE OF THROTTLE BODY, OPPOSITE THROTTLE LINKAGE

2 = ABOVE ACCELERATOR PEDAL

MAF LOCATION:

A = IN AIR INTAKE DUCT

B = INSIDE AIR CLEANER HOUSING

C = ON INTAKE MANIFOLD PLENUM

D = ATTACHED TO AIR CLEANER HOUSING

E = RIGHT REAR OF ENGINE COMPARTMENT

Optional O2 Sensor Signal connections

O2 Type

3 wire

4 wire

5 wire

Wire Color

Black

Varies you need factory wiring diagram to verify O2 sensor output signal

Varies you need factory wiring diagram to verify O2 sensor output signal

BMW

<u>Year</u>	<u>Model</u>	<u>Engine</u>	<u>TPS Wire Color</u>	<u>TPS Location</u>	<u>MAF Wire Color</u>	<u>MAF Location</u>	<u>Footnotes</u>
2000	323	2.5L	BROWN	1	YELLOW	A	(**)
2000	328	2.8L	BROWN	1	YELLOW	A	(**)
2001-2006	325	2.5L	BRWN/BLUE	1	YELLOW	A	(**)
2001-2006	330	3.0L	BRWN/BLUE	1	YELLOW	A	(**)
2007-2008	328	3.0L	YEL/BLUE	1	YEL/WHITE	A	(**)
2009-2011	328,330,335	3.0L	YEL/BLUE	1	YEL/WHITE	A	(**)

Footnotes

(**) = Indicates that you will be connecting to the (MAF) Mass air flow sensor, all others connect to the (MAP) Manifold Absolute Press Sensor

TPS Locations

1 = The (TPS) Throttle position sensor is located on the throttle bodu on the opposite side of the throttle linkage

MAF/MAP Sensor Locations

A = In air intake assembly

B = Front of engine compartment in Intake manifold next to Throttle body

NOTE: FOR OPTIONAL 02 SENSOR WIRING SEE CHART ON PAGE 29

FIAT

<u>Year</u>	<u>Model</u>	<u>Engine</u>	<u>TPS Wire Color</u>	<u>TPS Location</u>	<u>MAP Wire Color</u>	<u>MAP Location</u>
2012	500	1.4L 8V	Orange/Blk	1	Brown	A
2012	500	1.4L 16V	Grey/Dk Blu	1	Wht/Red	A

TPS LOCATION:

1 = ON SIDE OF THROTTLE BODY, OPPOSITE THROTTLE LINKAGE

MAP LOCATION:

A = Remove Air cleaner assembly mounted to intake manifold

02 Sensor Signal connections

<u>O2 Type</u>	<u>Wire Color</u>
ALL	Black

HONDA

<u>Year</u>	<u>Model</u>	<u>Engine</u>	<u>Color</u>	<u>Location</u>	<u>Color</u>	<u>Location</u>
1989	ACCORD	ALL	RED/YEL	1	RED	E
1990-1993	ACCORD	ALL	RED/BLK	1	WHT/BLU	G
1994-1997	ACCORD	2.2L	RED/BLK	1	WHT/YEL	A
1995	ACCORD	2.7L	RED/BLK	1	WHT/YEL	H
1996-1997	ACCORD	2.7L	RED/BLK	1	WHT/YEL	A
1998	ACCORD	2.3L	RED/BLK	1	RED/GRN	B
1998-2004	ACCORD	ALL	RED/BLK	1	RED/GRN	B
2005-2012	ACCORD	ALL	RED/BLK	1	GRN/RED	B
2013-2015	ACCORD	ALL	RED/BLK	1	PURPLE	B
1989	CIVIC	ALL	RED/BLU	1	WHITE	A
1990-1991	CIVIC	ALL	RED/BLU	1	GRN/WHT	G OR A
1992	CIVIC	ALL	LT GREEN	1	WHITE	A OR B
1993	CIVIC	ALL	PNK/BLK	1	WHITE	A OR B
1994	CIVIC	1.5,1.6L	RED/BLU	1	WHITE	A OR B
1995	CIVIC	1.5,1.6L	RED/BLU	1	WHITE	K
1996	CIVIC	1.6L	RED/BLK	1	RED/GRN	L
1997	CIVIC	1.6L	RED/BLK	1	RED/GRN	L
1998-2004	CIVIC	ALL	RED/BLK	1	RED/GRN	B
2005-2012	CIVIC	ALL	RED/BLK	1	GRN/RED	B
1998-2007	CR-V	2.0L,2,4L	RED/BLK	1	RED/GRN	B
2008-2012	CR-V	2.4L	RED/BLK	1	GRN/RED	B
2010-2012	CROSSTOUR	3.5L	RED	1	PURPLE	N
1993-1994	DEL SOL	1.5L	RED/BLU	1	WHITE	A OR B
1996-1999	DEL SOL	1.6L	RED/BLU	1	WHITE	L
2005-2007	ELEMENT	ALL	RED/BLK	1	GRN/RED	M
2007-2008	FIT	1.5L	RED/BLK	1	RED/GRN	O
2009-2012	FIT	1.5L	RED/BLK	1	GRN/RED	B
1995	ODYSSEY	2.2L	RED/BLK	1	WHT/YEL	K
2003-2012	PILOT	ALL	RED/BLK	1	RED/GRN	B
1989-1990	PRELUDE	ALL	RED/YEL	1	WHT/BLU	J
1992-1993	PRELUDE	ALL	RED/BLK	1	WHT/BLU	A
1994	PRELUDE	2.2,2.3L	RED/BLK	1	WHT/BLU	A

CONTINUED NEXT PAGE

1995	PRELUDE	2.2,2.3L	RED/BLK	1	WHT/BLU	B
1998-2001	PRELUDE	2.2L	RED/BLK	1	RED/GRN	B
2006-2012	RIDGELINE	ALL	RED/BLK	1	GRN/RED	B
2000-2004	S2000	ALL	RED/BLK	1	RED/GRN	B
2005-2009	S2000	ALL	RED/BLK	1	GRN/RED	B

MAP LOCATIONS

- A = Mounted to the center of the firewall
- B = Mounted on the top of the throttle body housing
- C = Mounted on the drivers side shock tower
- D = Mounted on the passenger side shock tower
- E = Mounted inside the emission control box on the firewall
- F = Mounted on the passenger side of the engine, on the fuel rail
- G = Mounted on the passengers side of the firewall in the emission control box
- H = Mounted on the drivers side top of engine
- I = Mounted on the passengers side of engine, on the intake manifold
- J = Mounted on passengers side floorboard near computer
- K = Mounted on top of engine, in the center
- L = Mounted on top of the engine, on the air intake assembly
- M = Mounted on the left side of the intake manifold near throttle body
- N = Mounted on the left side of the engine
- O = Mounted on rear of Intake manifold

TPS LOCATIONS

1 = The TPS (throttle position sensor) is located on the throttle body on the opposite side of the throttle shaft linkage

2 = The APP (accelerator pedal position sensor) is located on the right hand side of the engine compartment, it has cable going to a plastic housing and the sensor is mounted to the housing.

NOTE: FOR OPTIONAL 02 SENSOR WIRING SEE CHART ON PAGE 29

HYUNDAI

<u>Year</u>	<u>Model</u>	<u>Engine</u>	<u>Color</u>	<u>TPS</u> <u>Location</u>	<u>MAP/</u> <u>MAF Wire</u> <u>Color</u>	<u>MAP/</u> <u>MAF</u> <u>Location</u>	<u>Footnotes</u>
2011-2012	Equus	4.6L	BROWN	1	BLUE	B	(**)
2008-2012	Azera	3.3L	GREEN	1	YELLOW	F	
2013-2014	Elantra	1.8	PINK.BLK	1	BLUE	E	
2010-2012	Genesis Coupe	2.0L	WHT/BLK	1	PINK/BLK	A	
2010-2012	Genesis Coupe	3.8L	GREEN	1	YELLOW	A	
2010	Genesis	3.3L	BLUE	1	GRN/WHT	C	
2010-2012	Genesis	3.8L	ORANGE	1	GRN/WHT	C	
2010	Genesis	4.6L	GREEN	1	PURPLE	B	(**)
2011-2012	Genesis	4.6L	BROWN	1	BLUE	B	(**)
2008	Santa Fe	2.7L	GREEN	1	BROWN	H	
2009	Santa Fe	2.7L	RED	1	BROWN	H	
2010-2012	Santa Fe	2.4L	PINK/BLK	1	BLUE/ORG	H	
2008-2009	Santa Fe	3.3L	GREEN	1	YELLOW	H	
2010-2012	Santa Fe	3.5L	GREEN	1	BLACK	H	
2011-2012	Sonata	2.0L	PINK/BLK	1	BLUE	E	
2007-2008	Sonata	2.4L	PINK/BLK	1	ORANGE	B	(**)
2009-2010	Sonata	2.4L	PINK/BLK	1	BLU/ORANGE	B	(**)
2011-2012	Sonata	2.4L	PINK/BLK	1	BLUE	E	
2003-2004	Tiburon	2.0L	WHITE	1	GRN/WHT	A	
2003-2004	Tiburon	2.7L	BLUE	1	BLU/WHT	A	(**)
2005-2008	Tiburon	2.0L	WHITE	1	GRN/WHT	B	(**)
2005-2008	Tiburon	2.7L	BLUE	1	BLUE	B	(**)
2008-2009	Tucson	2.0L	BLUE	1	GREY	B	(**)
2010-2012	Tucson	2.0L 2.4L	PINK/BLU	1	BLUE	G	
2008-2009	Tucson	2.7L	BLUE	1	BLUE	B	(**)
2008-2012	Veracruz	3.8L	GREEN	1	YELLOW	H	

CONTINUED NEXT PAGE

Footnotes

(**) = Indicates that you will be connecting to the (MAF) Mass Air Flow Sensor, all others connect to the (MAP) Manifold Absolute Pressure Sensor

TPS Locations

1 = The (TPS) Throttle position sensor is located on the throttle body

MAP/MAF Sensor Locations

A = On top of intake manifold

B = Mounted to air intake tube between throttle body and air cleaner

C= Top of Intake Manifold near the throttle body.

D= MAP sensor is located on the intake manifold to the right and down from the dipstick.

E= MAP is located on the intake manifold near the throttle body

F =MAP is on the Right rear of engine on Intake Manifold

G = MAP is mounted to the top center of the engine

H = MAP is on the top rear of the engine

Note: Wiring diagrams and photos are available from www.hmaservice.com and kiatechinfo.com (factory service websites) if you need additional help with locations, etc.

NOTE: FOR OPTIONAL 02 SENSOR WIRING SEE CHART ON PAGE 29

INFINITI

<u>Year</u>	<u>Model</u>	<u>Engine</u>	<u>TPS WIRE Color</u>	<u>TPS Location</u>	<u>MAF/ MAP Wire Color</u>	<u>MAF/ MAP PIN TERM#</u>	<u>MAF/ MAP Location</u>	<u>Footnotes</u>
2008-2012	EX35	3.5L	YELLOW	1	LT BLUE	#3	J	(**)
2011-2012	FX35	3.5L	YELLOW	1	LT BLUE	#3	J	(**)
2009-2012	FX50	5.0L	BLUE	1	BLUE	#3	J	(**)
2000	G20	2.0L	YELLOW	1	WHITE	N/A	G	
2001-2002	G20	2.0L	YELLOW	1	BLUE	# 1	F	(**)
2011-2012	G25	2.5L	RED	1	WHITE	#3	I	(**)
2003	G35	3.5L	WHITE	1	LT GRN	# 1	F	(**)
2004-2007	G35 2 DOOR	3.5L	WHITE	1	ORANGE	# 4	F	(**)
2004-2007	G35 SEDAN	3.5L	YELLOW	1	LT BLU	N/A	F	(**)
2008-2012	G37	3.7L	RED	1	LT BLU	#3	J	(**)
2000-2001	I30	3.0L	BLU/WHT	1	WHITE	N/A	H	
2002-2004	I35	3.5L	WHITE	1	WHITE	# 1	F	(**)
2006-2008	M35	3.5L	WHITE	1	WHITE	# 4	E	(**)
2009-2010	M35	3.5L	ORANGE	1	BLUE	# 4	J	(**)
2011-2012	M37	3.7L	ORANGE	1	BLUE	N/A	H	
2003-2004	M45	4.5L	BLK/WHT	1	BLK/YEL	# 1	A	(**)
2005	M45	4.5L	BLACK	1	BLK/YEL	# 4	A	(**)
2006-2010	M45	4.5L	WHITE	1	WHITE	# 4	E	(**)
2011-2012	M56	5.6L	RED	1	RED	N/A	K	
2004-2010	QX56	5.6L	BLACK	1	WHITE	# 4	E	(**)
2011-2012	QX56	5.6L	RED	1	PURPLE	N/A	H	

Footnotes

(**) = Indicates you will be connecting to the Mass Air Flow Sensor (MAF) all others connect to Manifold Absolute Pressure Sensor (MAP)

TPS Locations

1 = On side of the throttle body , opposite the throttle linkage.

CONTINUED NEXT PAGE

MAF/MAP Sensor Locations

A = On air inlet duct, behind air cleaner assembly

B = On air cleaner housing

C = On right side of engine, part of the air intake assembly

D = Near throttle body

E = Left front of engine compartment

F = On air intake housing

G = Center of firewall

H = On top left rear of engine

I = In left air intake duct

J = In right air intake duct

K = On top of engine

L = Left rear of engine compartment on air intake

NOTE: FOR OPTIONAL 02 SENSOR WIRING SEE CHART ON PAGE 29

KIA

2010-12	Forte	2.0L	PINK	1	PINK	D	
2010-12	Forte	2.4L	PINK	1	PINK	D	
2006-2010	Sedona	3.8L	GREEN	1	YELLOW	E	
2010-2011	Rio, Soul	1.6,2.0L	YELLOW	1	PINK	H	
2005-2010	Sportage	2.0L	PINK	1	LAVND/ORNG	B	(**)
2005-2010	Sportage	2.7L	LAVENDR	1	GREEN	B	(**)

Footnotes

(**) = Indicates that you will be connecting to the (MAF) Mass Air Flow Sensor, all others connect to the (MAP) Manifold Absolute Pressure Sensor

TPS Locations

1 = The (TPS) Throttle position sensor is located on the throttle body

MAP/MAF Sensor Locations

A = On top of intake manifold

B = Mounted to air intake tube between throttle body and air cleaner

C= Top of Intake Manifold near the throttle body.

D= MAP sensor is located on the intake manifold to the right and down from the dipstick.

E= MAP is located on the intake manifold near the throttle body

F =MAP is on the Right rear of engine on Intake Manifold

G = MAP is mounted to the top center of the engine

H = MAP is on the top rear of the engine

Note: Wiring diagrams and photos are available from www.hmaservice.com and kiatechinfo.com (factory service websites) if you need additional help with locations, etc.

NOTE: FOR OPTIONAL 02 SENSOR WIRING SEE CHART ON PAGE 29

LAND ROVER / RANGE ROVER

<u>Year</u>	<u>Model</u>	<u>Engine</u>	<u>TPS Wire Color</u>	<u>TPS Location</u>	<u>MAP/ MAF Wire Color</u>	<u>MAP/ MAF Location</u>	<u>Footnotes</u>
2000-2002	DISCOVERY	4.0L	YEL/GRN	1	BLU/GRN	B	(**)
2003-2004	DISCOVERY	4.6L	YEL/GRN	1	BLU/GRN	B	(**)
2008-2009	LR2 HSE, SE	3.2L	BROWN	1	BLU/GRN	A	
2005-2009	LR3 HSE, SE	4.4L	RED	1	BLK/PRPL	A	
2006-2009	Range Rover HSE	4.2L	RED	1	BLK/PRPL	C	
2009	Range Rover HSE	4.4L	RED	1	BLK/PRPL	C	

Footnotes

(**) = Indicates that you will be connecting to the (MAF) Mass air flow sensor, all others connect to the (MAP) Manifold Absolute Press Sensor

TPS Locations

1 = The (TPS) Throttle position sensor is located on the throttle body

MAF/MAP Sensor Locations

A = Left front side of engine

B = In air intake assembly

C= Top rear of Engine

NOTE: FOR OPTIONAL O2 SENSOR WIRING SEE CHART ON PAGE 29

LEXUS

<u>Year</u>	<u>Model</u>	<u>Engine</u>	<u>TPS Color</u>	<u>TPS Location</u>	<u>MAP/ MAF Wire Color</u>	<u>MAP/ MAF Location</u>	<u>Footnotes</u>
2007-2012	ES350	3.5L	YELLOW	1	BLU/BLK	E	(**)
2001-2005	GS 300	3.0 L	YEL/GRN	1	RED/BLU	E	(**)
2006	GS 300	3.0 L	RED/LK	1	GRN/BLK	E	(**)
2007-2012	GS 350	3.5 L	RED/BLK	1	GRN/BLK	E	(**)
2001-2005	IS 300	3.0 L	WHT/RED	1	GRN/BLK	E	(**)
2006	IS 250	2.5 L	LTGRN	1	GREEN	E	(**)
2007-2012	IS 250	2.5 L	LTGRN	1	GREEN	E	(**)
2006	IS 350	3.5 L	RED/BLK	1	BLK/WHT	E	(**)
2007-2012	IS 350	3.5 L	RED/BLK	1	GRN/BLK	E	(**)
2007-2009	RX350	3.5L	GRN/RED	1	RED	E	(**)
2010-2012	RX350	3.5L	WHITE	1	RED	E	(**)

Footnotes

(**) = Indicates that you will be connecting to the (MAF) Mass Air Flow Sensor, all others connect to the (MAP) Manifold Absolute Pressure Sensor

TPS Locations

1 = The (TPS) Throttle position sensor is located on the throttle body

MAP/MAF Sensor Locations

A = MAP is located on the throttle body

B = Top rear of engine

C= Right rear of engine

D= Front of engine in air intake assembly.

E= MAF is located in the air Intake duct

Note: Wiring diagrams and photos are available from <https://techinfo.toyota.com>

(factory service website) if you need additional help with locations, etc. Note Toyota does charge a fee for the site

NOTE: FOR OPTIONAL 02 SENSOR WIRING SEE CHART ON PAGE 29

MAZDA

<u>Year</u>	<u>Model</u>	<u>Engine</u>	<u>Trans</u>	<u>TPS Wire Color</u>	<u>TPS Location</u>	<u>MAF/ MAP Wire Color</u>	<u>MAF/ MAP Location</u>	
2011-2012	2	1.5L		GRN/WHT	1	BROWN/BLK	K	
2004-2005	3	2.0L,2.3L		WHT/BLU	1	WHT/GRN	K	
2006-2009	3	2.0L,2.3L		BROWN	1	WHT/GRN	K	
2010-2011	3	2.0, 2.5L		BROWN	1	RED	K	
2005-2010	5	2.3L		BROWN	1	.AVNDR/WHT	K	
2003-2008	6	2.3L		BROWN	1	YEL/BLK	H	
2003-2008	6	3.0L		BROWN	1	BLU/BLK	J	(**)
2009-2012	6	2.5L		WHT/RED	1	WHT/GRN	H	
2010-2012	CX7	2.3L		RED	1	WHITE	F	(**)
2010-2012	CX7	2.5L		BROWN	1	WHT/DKGRN	L	
1990-1991	MIATA	ALL	AUTO	RED/BLK	1	RED	A	(**)
1990-1991	MIATA	ALL	MAN	BLK/LT GRN	1	RED	A	(**)
1992-1993	MIATA	ALL	AUTO	RED/BLK	1	RED	B	(**)
1992-1993	MIATA	ALL	MAN	BLK/LT GRN	1	RED	B	(**)
1994-1995	MIATA	ALL		RED/BLK	1	RED	B	(**)
1996-1997	MIATA	ALL		RED/BLK	1	RED/WHT	B	(**)
1999-2000	MIATA	ALL		GRN/BLK	1	LT GRN/BLK	G	(**)
2001-2005	MIATA	ALL		GRN/BLK	1	PINK	G	(**)
2006-2007	MIATA	ALL		BLK/GRN	1	BLU/YELLOW	H	
2008-2012	MIATA	ALL		BROWN	1	.AVENDR/YEI	H	
1992-1993	MX-3	ALL		GRN/YEL	1	RED	D	(**)
1994-1995	MX-3	1.6L		BLUE/WHT	1	LT GRN/BLK	D	(**)
1994	MX-3	1.8L		BLUE/WHT	1	RED	D	(**)
1990-1992	MX-6	ALL		LT GRN/WHT	1	RED/BLK	A	(**)
1993	MX-6	2.0L		PNK/GRN	1	BLK/BLUE	B	(**)
1993-1994	MX-6	2.5L		PNK/GRN	1	RED	B	(**)
1994	MX-6	2.0L	AUTO	PNK/BLUE	1	BLK/BLUE	B	(**)
1994	MX-6	2.0L	MAN	PNK/GRN	1	BLK/BLUE	B	(**)
1995	MX-6	2.0L	AUTO	PNK/BLUE	1	BLK/BLUE	F	(**)
1995	MX-6	2.0L	MAN	PNK/GRN	1	BLK/BLUE	F	(**)

CONTINUED NEXT PAGE

1995	MX-6	2.5L		PNK/GRN	1	RED	F	(**)
1996-1997	MX-6	2.0L	AUTO	PNK/BLUE	1	BLK/BLUE	F	(**)
1996-1997	MX-6	2.0L	MAN	PNK/GRN	1	BLK/BLUE	F	(**)
1996-1997	MX-6	2.5L		PNK/GRN	1	RED	F	(**)
1990-1994	PROTÉGÉ	ALL		LT GRN/WHT	1	RED	B	(**)
1995	PROTÉGÉ	ALL		BLUE/YEL	1	LT GRN/BLK	B	(**)
1996-1999	PROTÉGÉ	ALL		BLUE/YEL	1	LT GRN/BLK	F	(**)
2000-2003	PROTÉGÉ	ALL		BRN/YEL	1	LT GRN/BLK	G	(**)
1990	RX-7	ALL		GRN/RED	1	RED	C	(**)
1991	RX-7	ALL		GRN/RED	1	RED	A	(**)
2008-2012	RX-8	ALL		RED	1	YEL/RED	D	(**)
2001-2004	TRIBUTE	ALL		GRY/WHT	1	LT BLU/RED	F	(**)
2005-2008	TRIBUTE	2.3L		GRY/WHT	1	LT GRN/BLK	I	
2005-2008	TRIBUTE	3.0L		GRY/WHT	1	LTBLU/RED	I	
2009-2012	TRIBUTE	2.5L		BROWN	1	LAV/GRN	I	
2009-2012	TRIBUTE	3.0L		BROWN	1	LAV/GRN	I	

Footnotes

(**) = Indicates that you will be connecting to the MAF (Mass Air Flow) Sensor, all others connect to MAP (Man. Absolute Press.) Sensor

TPS Location

1 = The TPS (Throttle position sensor) is located on the throttle body on the opposite end of the throttle shaft linkage.

MAF/MAP Sensor location

A = Connected to air filter housing

B = On top of air filter housing

C = Under air cleaner assembly

D = In Air cleaner assembly

E = Center of Firewall

F = Left side of engine in air intake duct

G = Left side front corner of engine compartment in air intake duct

H = Left rear of engine

I = Right rear of engine compartment

J = Rear of engine

K = Near front of engine compartment

L = Left rear of engine compartment

NOTE: FOR OPTIONAL O2 SENSOR WIRING SEE CHART ON PAGE 29

MINI

<u>Year</u>	<u>Model</u>	<u>Engine</u>	<u>TPS Wire Color</u>	<u>TPS Location</u>	<u>MAP Wire Color</u>	<u>MAP/MAF Location</u>	<u>Footnotes</u>
2002-2007	Mini Cooper (not the S)	1.6L	BLUE	1	YEL/BLUE	B	
2008-2011	Mini Cooper (not the S)	1.6L	BLUE	1	WHITE	A	(**)

Footnotes

(**) = Indicates that you will be connecting to the (MAF) Mass air flow sensor, all others connect to the (MAP) Manifold Absolute Press Sensor

TPS Locations

1 = The (TPS) Throttle position sensor is located on the throttle bodu on the opposite side of the throttle linkage

MAF/MAP Sensor Locations

A = In air intake assembly

B = Front of engine compartment in Intake manifold next to Throttle body

NOTE: FOR OPTIONAL 02 SENSOR WIRING SEE CHART ON PAGE 29

MITSUBISHI

Year	Model	Engine	TPS		MAP /		
			Color	Location	MAF Wire Color	MAP/MAF Location	
1991-1999	3000GT	3.0L	BRN/RED	1	ORANGE	C	(**)
1992-1999	3000GT	3.0L TURBO	BRN/RED	1	ORANGE	C	(**)
1990-1994	ECLIPSE	ALL	GRN/WHT	1	GRN/YEL	A	(**)
1995-1999	ECLIPSE	2.0L	BRN/RED	1	YEL/BLK	D	
1995-1999	ECLIPSE	2.0L TURBO, 2.4L	BRN/RED	1	ORANGE	B	(**)
2000-2003	ECLIPSE	2.4L,3.0L	YELLOW	1	BLU/RED	C	(**)
2004-2005	ECLIPSE	2.4L,3.0L	YELLOW	1	LT BLU	D	(**)
2006-2007	ECLIPSE	2.4L,3.8L	RED/WHT	1	BLU/RED	E	
2008-2010	ECLIPSE	2.4L, 3.8L	RED/WHT	1	BLACK	E	
1991	GALANT	2.0L	GRN/WHT	1	GRN/YEL	A	(**)
1991	GALANT	2.0L TURBO	GRN/WHT	1	GRN/YEL	A	(**)
1992	GALANT	2.0L	GRN/WHT	1	GRN/YEL	A	(**)
1992	GALANT	2.0L TURBO	GRN/WHT	1	GRN/YEL	A	(**)
1995-1999	GALANT	2.4L,3.0L	BRN/RED	1	YEL/BLK	D	(**)
2000-2003	GALANT	2.4L, 3.0L	BRN/WHT	1	BLU/RED	C	(**)
2004-2007	GALANT	2.4L,3.8L	RED/WHT	1	BLU/RED	E	
2008-2010	GALANT	2.4L, 3.8L	RED/WHT	1	BLACK	E	
2002-2003	LANCER	2.0L	GRN	1	WHT	C	(**)
2004-2005	LANCER	2.0L, 2.4L	GRN	1	LT GRN/WHT	E	
2006-2007	LANCER	2.0,2.4L	GRN	1	LT GRN/WHT	E	
2008-2010	LANCER	2.0,2.4L	GREY/RED	1	YEL/BLK	F	

Footnotes

(**) = Indicates that you will be connecting to the MAF (Mass Air Flow Sensor) all others connect to the MAP (Manifold Pressure) Sensor

TPS Locations

1 = The TPS (Throttle Position Sensor) is located on the throttle body on the opposite end of the throttle shaft linkage.

MAF/MAP Sensor locations

A = In Air cleaner housing

F= On engine Pass side front

B = Right (Drivers) side of engine compartment on air cleaner.

C = On Air cleaner assembly

D = Top right (Drivers) side of engine

E = On top of Intake Manifold

NOTE: FOR OPTIONAL 02 SENSOR WIRING SEE CHART ON PAGE 29

NISSAN

<u>Year</u>	<u>Model</u>	<u>Engine</u>	<u>TPS WIRE Color</u>	<u>TPS Location</u>	<u>MAF/ MAP Wire Color</u>	<u>MAF/ MAP PIN TERM#</u>	<u>MAF/ MAP Location</u>	<u>Footnotes</u>
1995-1998	200SX	1.6L	YELLOW	1	GREEN	N/A	A	(**)
1995-1998	200SX	2.0L	YELLOW	1	ORANGE	N/A	A	(**)
1990-1998	240SX	ALL	WHITE	1	WHITE	N/A	A	(**)
1993-1997	300ZX	ALL	WHITE	1	WHITE	# B	A	(**)
1998-2000	300ZX	ALL	WHITE	1	WHITE	# 5	A	(**)
2003-2006	350Z	ALL	GREEN	1	ORANGE	# 4	A	(**)
2007-2009	350Z	ALL	BLUE/GRN	1	BLU/WHT	# 4	B	(**)
2009-2012	370Z	ALL	YELLOW	1	LT. BLUE	#3	B	(**)
1998-2001	ALTIMA	ALL	YELLOW	1	BROWN	# 1	A	(**)
1993-1997	ALTIMA	ALL	WHITE	1	ORANGE	# D	B	(**)

<u>Year</u>	<u>Model</u>	<u>Engine</u>	<u>TPS WIRE Color</u>	<u>TPS Location</u>	<u>MAF/ MAP Wire Color</u>	<u>MAF/ MAP PIN TERM#</u>	<u>MAF/ MAP Location</u>	<u>Footnotes</u>
2002-2006	ALTIMA	ALL	WHITE	1	YEL/GRN	# 5	A	(**)
2007-2009	ALTIMA	ALL	RED	1	ORANGE	# 3	B	(**)
2010-2013	ALTIMA	ALL	RED	1	GREY	#3	B	(**)
2014-2017	ALTIMA	ALL	WHITE	1	YELLOW	#2	B	(**)
2004-2012	ARMADA	ALL	BLACK	1	WHITE	# 4	E	(**)
2009-2012	CUBE	ALL	LT. GREEN	1	GREEN	# 3	F	(**)
1990-1995	FRONTIER	ALL	BLUE	1	RED	# 4	A	(**)
2001-2005	FRONTIER	ALL	BLUE	1	RED	# 4	D	(**)
2006-2012	FRONTIER	ALL	WHITE	1	PINK	# 4	E	(**)
2011-2012	JUKE	ALL	GREEN	1	GREEN	# 4	F	(**)
1996-2003	MAXIMA	ALL	WHITE	1	WHITE	# B	A	(**)
1990-1995	MAXIMA	ALL	WHITE	1	WHITE	# 1	A	(**)
2004-2005	MAXIMA	ALL	WHITE	1	YEL/ORNG	# 2	A	(**)
2006-2008	MAXIMA	ALL	WHITE	1	GRN/ORG	#4	F	(**)
2009-2012	MAXIMA	ALL	RED	1	ORANGE	#3	F	(**)
2003-2009	MURANO	ALL	WHITE	1	GRN/WHT	# 4	E	(**)
2009-2012	MURANO	ALL	WHITE	1	ORANGE	#3	E	(**)

CONTINUED NEXT PAGE

1996-1997	PATHFINDER	4 CYL	WHITE	1	WHITE	# C	96-C, 97-A	(**)
1990-1995	PATHFINDER	6 CYL	WHITE	1	WHITE	# C	A	(**)
1996-2000	PATHFINDER	6 CYL	WHITE	1	WHITE	# 1	C	(**)
2001-2002	PATHFINDER	ALL	RED	1	ORANGE	# 1	A	(**)
2003-2005	PATHFINDER	ALL	BROWN	1	ORANGE	# 4	A	(**)
2006-2012	PATHFINDER	ALL	WHITE	1	PINK	# 4	F	(**)
1990-1994	PICKUP	ALL	WHITE	1	WHITE	# C	A	(**)
1995-2000	PICKUP	ALL	WHITE	1	WHITE	# 1	A	(**)
2004-2007	QUEST	ALL	YELLOW	1	WHT/BLU	# 3	E	(**)
2008-2012	ROGUE	ALL	GREEN	1	GREEN	# 3	F	(**)
2000	SENTRA	ALL	YELLOW	1	GREEN	# 1	A	(**)
2001	SENTRA	1.6L	WHITE	1	GREEN	# 1	A	(**)
2001	SENTRA	1.8L	YELLOW	1	GREEN	# 1	A	(**)
2002	SENTRA	1.8L	YELLOW	1	GREEN	# 1	B	(**)
2002-2003	SENTRA	2.5L	WHITE	1	ORNG/BLU	N/A	E	(**)
2003	SENTRA	1.8L	WHITE	1	BLU/RED	N/A	E	(**)
2004-2006	SENTRA	ALL	WHITE	1	BLU/RED	N/A	E	(**)
2007-2009	SENTRA	ALL	YEL/BLK	1	VIOLET	# 4	F	(**)
2010-2012	SENTRA	ALL	GREEN	1	PURPLE	# 4	F	(**)
2004-2012	TITAN	ALL	BLACK	1	WHITE	# 4	E	(**)
2007-2012	VERSA	ALL	LT GREEN	1	GREEN	# 3	L	(**)
2001-2005	XTERRA	ALL	BLUE	1	RED	# 4	D	(**)
2006-2012	XTERRA	ALL	WHITE	1	PINK	# 4	E	(**)

Footnotes

(**) = Indicates you will be connecting to the Mass Air Flow Sensor (MAF) all others connect to Manifold Absolute Pressure Sensor (MAP)

TPS Locations

1 = On side of the throttle body , opposite the throttle linkage.

CONTINUED NEXT PAGE

MAF/MAP Sensor Locations

- A = On air inlet duct, behind air cleaner assembly
- B = On air cleaner housing
- C = On right side of engine, part of the air intake assembly
- D = Near throttle body
- E = Left front of engine compartment
- F = On air intake housing
- G = Center of firewall
- H = On top left rear of engine
- I = In left air intake duct
- J = In right air intake duct
- K = On top of engine
- L = Left rear of engine compartment on air intake

NOTE: FOR OPTIONAL O2 SENSOR WIRING SEE CHART ON PAGE 29

SCION

2013	FR-S	2.0L	WHT/RED	1	ORANGE	L	
2005-2010	TC	2.4L	LT GRN	1	RED #5	K	(**)
2011-2015	TC	2.5L	LT GRN	1	PINK	K	(**)
2004-2007	XA	1.5L	YEL/RED	1	PINK	K	(**)
2004-2007	XB	1.5L	YEL/RED	1	PINK	K	(**)
2008-2011	XB	2.4L,2.5L	LT GRN	1	PINK	K	(**)

Footnotes

(**) = Indicates that you will be connecting to the (MAF) Mass Air Flow Sensor, all others connect to the (MAP) Manifold Absolute Pressure Sensor

TPS Locations

1 = The (TPS) Throttle position sensor is located on the throttle bodu on the opposite side of the thrttle linkage

MAF/MAP Sensor Locations

A = In front of air cleaner assembly

B = On top of air cleaner assembly

C = next to air cleaner box

D = Behind air filter assembly

E = Center of firewall

F = Passenger side rear corner of engine compartment

G = Left (drivers) side of firewall

H = Right (pasengers) side of firewall

I = Right side of engine on air intake

J = left rear of engine compartment

K = Left front of engine compartment

L = On top rear of engine on Intake Manifold

NOTE: FOR OPTIONAL O2 SENSOR WIRING SEE CHART ON PAGE 29

SUBARU

<u>Year</u>	<u>Model</u>	<u>Engine</u>	<u>TPS Color</u>	<u>TPS Location</u>	<u>MAP/ MAF Wire Color</u>	<u>MAP/ MAF Location</u>	<u>Footnotes</u>
2013	BRZ	2.0L	WHT/RED	1	ORANGE	L	
2004-2005	Impreza	2.0L Turbo	Yel/Green	1	Pink/Blue	E	(**)
2004-2005	Impreza	2.5L Non Turbo	Wht/Red	1	Red	B	
2004-2005	Impreza	2.5L Turbo	White	1	Pink/Blue	E	(**)
2006-2011	Impreza	2.5L Non Turbo	Yel/Green	1	Blue/Yellow	C	
2006-2007	Impreza	2.5L Turbo	Yel/Green	1	Pink/Blue	E	(**)
2008-2011	Impreza	2.5L Turbo	Green	1	Blue/Red	E	(**)
2000-2001	Legacy/Forester	2.5L Non Turbo	White	1	White	A	
2002-2004	Legacy/Forester	2.5L Non Turbo	White	1	Red	B	
2006-2011	Legacy	2.5L Non Turbo	White	1	Blue/Yellow	C	
2006-2011	Legacy	2.5L Turbo	White	1	Red/Blue	D	(**)
2009-2010	Legacy	3.0L	White	1	Red/Blue	D	(**)
2010-2011	Legacy	3.6L	White	1	White	E	(**)
2005-2011	Outback	2.5L Non Turbo	White	1	Blue/Yellow	C	
2005-2011	Outback	2.5L Turbo	White	1	Red/Blue	E	(**)

Footnotes

(**) = Indicates that you will be connecting to the (MAF) Mass Air Flow Sensor, all others connect to the (MAP) Manifold Absolute Pressure Sensor

TPS Locations

1 = The (TPS) Throttle position sensor is located on the throttle body

MAP/MAF Sensor Locations

A = MAP is located on the throttle body

B = Top rear of engine

C= Right rear of engine

D= Front of engine in air intake assembly.

E= MAF is located in air Intake duct

Note: Wiring diagrams and photos are available from <http://techinfo.subaru.com> (factory service website) if you need additional help with locations, etc.

NOTE: FOR OPTIONAL 02 SENSOR WIRING SEE CHART ON PAGE 29

SUZUKI

<u>Year</u>	<u>Model</u>	<u>Engine</u>	<u>TPS Wire Color</u>	<u>TPS Location</u>	<u>MAP/MAF Wire Color</u>	<u>MAP/MAF Location</u>	<u>Footnotes</u>
2009-2010	EQUATOR	2.5L	WHITE	1	BROWN	A	(**)
2009-2010	EQUATOR	4.0L	WHITE	1	BROWN	A	(**)
2001-2005	GRAND VITARA	2.5L	RED/GRN	1	RED/WHITE	B	
2006	GRAND VITARA	2.5L	WHITE	1	RED/WHITE	B	
2007-2008	GRAND VITARA	2.7L	WHITE	1	RED/WHITE	B	
2009-2010	GRAND VITARA	2.4L	BLACK	1	LTGREEN	A	(**)
2009-2010	GRAND VITARA	3.2L	WHITE	1	LTGRN/RED	A	(**)
2007-2010	SX4	2.0L	WHITE	1	GREY/BLU	A	(**)
2008-2010	SX4 CROSSOVER	2.0L	WHITE	1	GREY/BLU	A	(**)

Footnotes

(**) = Indicates that you will be connecting to the (MAF) Mass air flow sensor, all others connect to the (MAP) Manifold Absolute Press Sensor

TPS Locations

1 = The (TPS) Throttle position sensor is located on the throttle body

MAF/MAP Sensor Locations

A = In air intake assembly

B = Right rear of engine compartment

NOTE: FOR OPTIONAL 02 SENSOR WIRING SEE CHART ON PAGE 29

TOYOTA ----- 4 CYLINDER APPLICATIONS

<u>Year</u>	<u>Model</u>	<u>Engine</u>	<u>Color</u>	<u>TPS</u> <u>Location</u>	<u>MAP/</u> <u>MAF Wire</u> <u>Color</u>	<u>MAP/</u> <u>MAF</u> <u>Location</u>	<u>Footnotes</u>
1990-1991	4 RUNNER	4CYL	YELLOW	1	YEL/BLUE	A	(**)
1992-1994	4 RUNNER	4 CYL	YELLOW	1	YEL/BLUE	B	(**)
1995	4 RUNNER	4 CYL	YELLOW	1	YEL/BLUE	C	(**)
1996-2000	4 RUNNER	ALL	YELLOW	1	BLK/RED	D	(**)
2001-2002	4 RUNNER	ALL	BLU/YEL	1	YEL/GRN	D	(**)
2003-2007	4 RUNNER	4.0L	GRN/BLK	1	RED/BLK	I	(**)
2003-2007	4 RUNNER	4.7L	YELLOW	1	YEL/BLK	I	(**)
1990-1991	CAMRY	4 CYL	BLK/RED	1	YEL/BLUE	D	(**)
1992-1994	CAMRY	4 CYL	BLACK	1	BLK/YEL	E	
1996	CAMRY	4 CYL	BLACK	1	BLK/YEL	G	
1997-2006	CAMRY	4 CYL	LT GRN	1	BLK/YEL	G	
2006	CAMRY	4 CYL	LT GRN	1	BLU/BLK	I	(**)
2007-10	CAMRY	4 CYL	YELLOW	1	LT BLU	I	(**)
2011-2012	CAMRY	4 CYL	YELLOW	1	GREEN	I	(**)
1990-1992	CELICA	1.6L	PINK/BLK	1	GREY/BLK	E	
1990-1992	CELICA	2.0L	PINK/BLK	1	GREY/BLK	D	(**)
1990-1992	CELICA	2.2L	PINK/BLK	1	GREY/BLK	E	
1993	CELICA	1.6L	PINK/BLK	1	GREY/BLK	E	
1994	CELICA	4 CYL	BLK/WHT	1	GREY/BLK	E	
1995	CELICA	4 CYL	BLK/WHT	1	GREY/BLK	H	
1996	CELICA	1.8L	BLK/WHT	1	BLUE	H	
1996-1997	CELICA	2.2L	BLK/WHT	1	GREY/BLK	D	
1998-2000	CELICA	ALL	BLK/WHT	1	BLUE	H	
2001	CELICA	4 CYL	BLK/WHT	1	BLU/RED	D	(**)
2002	CELICA	4 CYL	BLK/WHT	1	GRN/WHITE	D	(**)
2003-2005	CELICA	ALL	BLK/WHT	1	YEL/RED	D	(**)
2000-2007	COROLLA	4 CYL	LT GRN	1	GREEN	K	(**)
2009-12	COROLLA	4 CYL	LT GRN	1	VIOLET	K	(**)
2001-2003	HIGHLANDER	ALL	BLK/WHT	1	RED/YEL	J	(**)
2004-2005	HIGHLANDER	ALL	RED/WHT	1	BLU/BLK	J	(**)

CONTINUED NEXT PAGE

2006-2007	HIGHLANDER	4 CYL	BLK/WHT	1	BLU/BLK	J	(**)
2010-2012	HIGHLANDER	4 CYL	VOLET	1	PINK	K	(**)
2003-2007	MATRIX	4 CYL	LT GRN	1	GREEN	J	(**)
2009	MATRIX	4 CYL	GREEN	1	VIOLET	J	(**)
1992	MR2	TURBO	WHITE	1	YEL/BLUE	D	(**)
1992	MR2	NO TURBO	WHITE	1	LT GRN/RED	F	
1993	MR2	4 CYL	WHITE	1	LT GRN/RED	F	
1994	MR2	TURBO	WHITE	1	YEL/RED	D	(**)
1994	MR2	NO TURBO	WHITE	1	LT GRN/RED	F	
1995	MR2	NO TURBO	WHITE	1	LT GRN/RED	C	
1990	PICKUP	4 CYL	YELLOW	1	YEL/BLUE	A	(**)
1992-1994	PICKUP	4 CYL	YELLOW	1	YEL/BLUE	B	(**)
1995	PICKUP	4 CYL	YELLOW	1	YEL/BLUE	C	(**)
2011-2015	PRIUS	4 CYL	YELLOW	1	BLACK	B	(**)
2016-2017	PRIUS	4 CYL	ORANGE	1	GREEN	B	(**)
1996-1997	RAV 4	4 CYL	BLU/RED	1	LTGRN/RED	E	
1998-2000	RAV 4	4 CYL	BLU/RED	1	LTGRN/BLK	E	(**)
2001-2005	RAV 4	ALL	BLU/RED	1	RED/WHT	E	(**)
2006-2011	RAV 4	4 CYL	GREEN	1	WHITE	J	(**)
2001-2005	SEQUOIA	ALL	BLK/YEL	1	YEL/GRN	I	(**)
1994-1998	T-100	ALL	BLU/RED	1	YEL/RED	D	(**)
1995-2000	TACOMA	ALL	YELLOW	1	GREY/RED	C	(**)
2001-2005	TACOMA	ALL	YELLOW	1	GREY	D	(**)
2006-2011	TACOMA	4 CYL	GRN/BLK	1	RED/YEL	C	(**)
2000-2006	TUNDRA	ALL	BLK/YEL	1	YEL/GRN	C	(**)
2007-2008	TUNDRA	4.0, 4.7L	BLU/YEL	1	YEL/BLK	D	(**)

CONTINUED NEXT PAGE

TOYOTA ----- 6 AND 8 CYLINDER APPLICATIONS

<u>Year</u>	<u>Model</u>	<u>Engine</u>	<u>TPS WIRE Color</u>	<u>TPS Location</u>	<u>MAF Wire Color</u>	<u>MAF Location</u>	<u>Footnotes</u>
1990	4 RUNNER	6 CYL	YELLOW	1	BLK/YEL	A	(**)
1991	4 RUNNER	6 CYL	YELLOW	1	YEL/RED	A	(**)
1992-1995	4 RUNNER	6 CYL	YELLOW	1	YEL/RED	D	(**)
1996	4 RUNNER	6 CYL	BLK/YEL	1	RED/WHITE	E	(**)
1997-2002	4 RUNNER	6 CYL	BLK/YEL	1	RED/WHITE	B	(**)
2001-2002	4 RUNNER	ALL	BLU/YEL	1	YEL/GRN	D	(**)
2003-2007	4 RUNNER	4.0L	GRN/BLK	1	RED/BLU	I	(**)
2008-2009	4 RUNNER	4.0L	GRN/BLK	1	RED/BLK	I	(**)
2010-2012	4 RUNNER	4.0L	LT GREEN	1	YELLOW	I	(**)
2003-2007	4 RUNNER	4.7L	YELLOW	1	YEL/BLK	I	(**)
1990-1991	CAMRY	6 CYL	BLACK	1	YEL/RED	B	(**)
1992-1993	CAMRY	6 CYL	BLUE	1	YEL/BLUE	B	(**)
1994-1997	CAMRY	6 CYL	BLK/YEL	1	RED	B	(**)
1998-2001	CAMRY	6 CYL	BLUE	1	PINK	B	(**)
2002-2006	CAMRY	6 CYL	LT GRN	1	BLU/BLK	E	(**)
2007-2011	CAMRY	6 CYL	YELLOW	1	PINK	I	(**)
2012	CAMRY	6 CYL	YELLOW	1	Blue/Blk	I	(**)
2009	COROLLA	1.8L	LT GREEN	1	VIOLET	A	(**)
2007-2008	FJ CRUISER	4.0L	GRN/BLK	1	RED	B	(**)
2010-2012	FJ CRUISER	4.0L	BLK/BLU	1	GREEN	B	(**)
2001-2003	HIGHLANDER	ALL	BLK/WHT	1	RED/YEL	J	(**)
2004-2007	HIGHLANDER	ALL	RED/WHT	1	BLU/BLK	J	(**)
2008-2010	HIGHLANDER	3.3L	WHT	1	RED	J	(**)
2008-2012	HIGHLANDER	3.5L	BLACK	1	RED	C	(**)
1990-1991	L-CRUISER	6 CYL	GRN/BLK	1	GRN/BLUE	B	(**)
1992-1994	L-CRUISER	6 CYL	GRN/BLK	1	GRN/BLUE	D	(**)
1995	L-CRUISER	6 CYL	GRN/BLK	1	GREEN	D	(**)
1996-1997	L-CRUISER	6 CYL	GRN/BLK	1	GREEN	E	(**)
1998-2000	L-CRUISER	6 CYL	RED/YEL	1	BLUE/YEL	E	(**)
2001-2007	L-CRUISER	ALL	RED/YEL	1	YEL/BLK	A	(**)
2008-2009	L-CRUISER	ALL	RED/YEL	1	BLU/YEL	A	(**)

CONTINUED NEXT PAGE

2010-2012	L-CRUISER	ALL	BLK/BLU	1	BLU/YEL	A	(**)
1990	PICKUP	6 CYL	YELLOW	1	YEL/BLUE	A	(**)
1991	PICKUP	6 CYL	YELLOW	1	YEL/RED	A	(**)
1992-1995	PICKUP	6 CYL	YELLOW	1	YEL/RED	D	(**)
2001-2005	RAV4	ALL	BLU/RED	1	RED/WHT	E	(**)
2006-2007	RAV4	ALL	GREEN	1	WHITE	J	(**)
2008-2012	RAV4	3.5L	YELLOW	1	GREY	J	(**)
2001-2008	SEQUOIA	ALL	BLK/YEL	1	YEL/GRN	I	(**)
2009-2012	SEQUOIA	4.6L	RED/YEL	1	BLU/YEL	I	(**)
2009-2012	SEQUOIA	5.7L	RED/YEL	1	BLU/YEL	I	(**)
1990-1991	SUPRA	6 CYL	WHT/RED	1	LT GRN/RED	C	(**)
1992	SUPRA	6 CYL	WHT/RED	1	LT GRN/RED	B	(**)
1993-1995	SUPRA	TURBO	YELLOW	1	YEL/RED	B	(**)
1993-1995	SUPRA	NO TURBO	YELLOW	1	LT. GRN/BLK	B	(**)
1996-1998	SUPRA	TURBO	YELLOW	1	YEL/RED	E	(**)
1996-1998	SUPRA	NO TURBO	YELLOW	1	YEL/RED	E	(**)
1993-1994	T-100	6 CYL	YELLOW	1	YEL/RED	D	(**)
1995	T-100	6 CYL	YEL/BLK	1	GREY/RED	D	(**)
1996-1998	T-100	6 CYL	YEL/BLK	1	GREY/RED	B	(**)
1995-2000	TACOMA	6 CYL	YELLOW	1	GREY/RED	E	(**)
2001-2004	TACOMA	ALL	YELLOW	1	GREY	E	(**)
2005-2007	TACOMA	ALL	GRN/BLK	1	RED/YEL	C	(**)
2008-2015	TACOMA	6 CYL	GRN/BLK	1	RED/YEL	C	(**)
2016-2017	TACOMA	2.7L	BLACK	1	PINK	C	(**)
2016-2017	TACOMA	3.5L	BLACK	1	ORANGE	C	(**)
2000-2002	TUNDRA	3.4L	BLK/YEL	1	RED/WHT	C	(**)
2000-2002	TUNDRA	4.0L	BLK/YEL	1	RED/WHT	C	(**)
2000-2002	TUNDRA	4.7L	BLK/YEL	1	RED/WHT	C	(**)
2003-2004	TUNDRA	3.4,4.0L	BLK/YEL	1	RED/WHT	C	(**)
2003	TUNDRA	4.7L	BLK/YEL	1	RED/WHT	C	(**)
2005	TUNDRA	4.0L	GREY	1	RED YELLOW	C	(**)
2006	TUNDRA	4.0L	GREY	1	RED/BLU	C	(**)
2000-2004	TUNDRA	4.7L	BLK/YEL	1	YEL/GRN	C	(**)
2005-2006	TUNDRA	4.7L	GREY	1	RED/YEL	C	(**)
2007-2009	TUNDRA	4.0L,4.7L,5.7L	RED/YEL	1	BLU/YEL	D	(**)

CONTINUED NEXT PAGE

2010-2012	TUNDRA	4.6L	RED/YEL	1	BLU/YEL	D	(**)
2007-2012	TUNDRA	5.7L	RED/YEL	1	BLU/YEL	D	(**)

Footnotes

(**) = Indicates that you will be connecting to the (MAF) Mass air flow sensor, all others connect to the (MAP) Manifold Absolute Press Sensor

TPS Locations

1 = The (TPS) Throttle position sensor is located on the throttle body on the opposite side of the throttle linkage

MAF/MAP Sensor Locations

A = In front of air cleaner assembly

B = Behind air cleaner assembly

C = On air filter housing

D = On top of air filter assembly

E = Attached to air filter housing

I = Right side of engine on air intake

J = left rear of engine compartment

NOTE: FOR OPTIONAL 02 SENSOR WIRING SEE CHART ON PAGE 29

VW

<u>Year</u>	<u>Model</u>	<u>Engine</u>	<u>TPS Wire Color</u>	<u>TPS Location</u>	<u>MAF Wire Color</u>	<u>MAF Location</u>	<u>Footnotes</u>
2006-2008	GTI	2.0L	GREEN/YEL	1	YELLOW	A	(**)
2006-2008	JETTA	2.0L	GREEN/YEL	1	YELLOW	A	(**)
2009-2010	JETTA	2.0L	BRWN/BLU	1	YELLOW	A	(**)
2009-2010	JETTA	2.5L	GRY/BLK	1	YELLOW	A	(**)

Footnotes

(**) = Indicates that you will be connecting to the (MAF) Mass air flow sensor, all others connect to the (MAP) Manifold Absolute Press Sensor

TPS Locations

1 = The (TPS) Throttle position sensor is located on the throttle bodu on the opposite side of the throttle linkage

MAF/MAP Sensor Locations

A = In air intake assembly

B = Front of engine compartment in Intake manifold next to Throttle body

NOTE: FOR OPTIONAL 02 SENSOR WIRING SEE CHART ON PAGE 29

Optional 02 Sensor Signal connections (all vehicles)

<u>Vehicle/Connector type</u>	<u>Wire Color</u>
Acura/Honda 4 Wire Connector	Black
Alfa Romeo 3 Wires	Black
Audi 3 Wires	Black
BMW 3 Wires	Black
BMW 4 Wires	Black
Chrysler 3 Wires	Black
Chrysler 4 Wires	Black
Chrysler Import 4 Wires	Black,Blue or Yellow
Ford 3 Wires	Black
Ford 4 Wires	Black
Geo 4 Wires	Black
GM 2 Wires	Black
GM 3 Wires	Black orPurple
GM 4 Wires	Black orPurple
Hyundai (All)	Black
Isuzu 3 Wires	Blue
Isuzu 4 Wires	Blue
Kia 3 Wires	Black
Lancia 3 Wires	Black
Mazda 3 Wires	Black
Mazda 4 Wires	Black
Mercury 3 Wires	Black
Mercury 4 Wires	Black
Mitsubishi 4 Wires	Black,Blue or Yellow
Nissan 3 Wires	Black
Nissan 4 Wires	Black
Subaru 3 Wires	Black
Suzuki 4 wires	Black
Toyota	Black
Volkswagon	White

AP020 AP013 AP036 | Dash or Console 3M™ Adhesive Mounting Disc



AP020 Disc
(Ø 90 mm)



AP013 Disc
(Ø 80 mm)



AP036 Disc
(Ø 70 mm)

Package Contents:

- (1) Self-adhesive dash or console pedestal mounting disc
- (1) Alcohol cleaning pad

No Tools Required for installation.

***Note:** Adhesive disc is intended for semi-permanent installation and one time application. If disc needs to be removed, please see the removal instructions below.

Dash or Console Mounting Instructions

- Step 1. Choose a suitable location for disc (and pedestal) installation. Do not place mount in or near an air bag deployment zone or where it will obstruct view of the road or hinder vehicle operation.
- Step 2. Clean the dash or console surface area thoroughly with the included alcohol pad. Allow the area dry before applying the mounting disc.

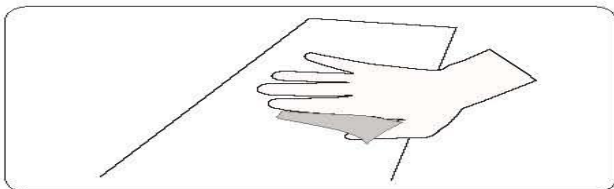

- Step 3. Remove the paper backing of the disc and place on the cleaned surface. Press the top of the disc down firmly to allow the adhesive to stick to the surface. Allow 24 hours for the adhesive to cure to the surface before applying any pressure.

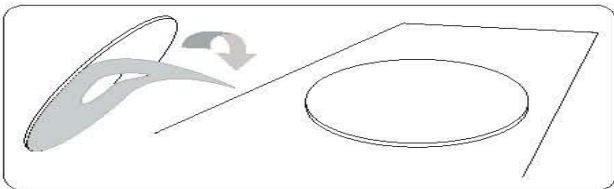

- Step 4. Place the suction cup of the pedestal (sold separately) firmly down on the center of the mounting disc and lower the securing lever.

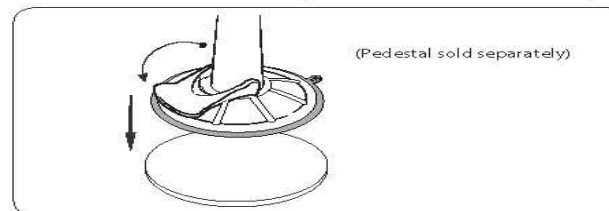

Disc Removal Instructions

- Step 1. Prepare the surface around the disc by applying a generous amount of rubbing alcohol or similar adhesive removal product to the area with a cotton swab. Let the liquid saturate the adhesive area for about a minute.
- Step 2. Take a long piece of dental floss in each hand and slowly work back and forth at the base of the adhesive disc. Gently use the dental floss to cut the adhesive from the dash or console until the black plastic disc is removed.

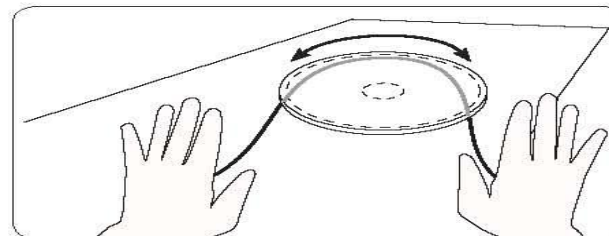

- Step 3. If the sticky adhesive area breaks apart or does not come off completely, re-apply a small amount of alcohol (or adhesive removal liquid) and carefully lift off the remaining area by hand.

GN014-SBH | Mini Windshield Suction Swivel Mount



Package Contents:

- (1) GN014 - Mini windshield mount
- (1) Swivel ball head assembly with dual T-tab pattern adapter plate and tightening ring.

Compatible with:

- All Arkon dual T-tab pattern phone cradles and adapter plates
- Most Garmin 17mm ball connections. (See website for full list.)

! Do not place mount in or near an air bag deployment zone or where it will obstruct view of the road.

Windshield Mounting

- Step 1.** Find a safe location on the interior of the vehicle's windshield to mount the pedestal. Firmly push the suction base (A) against the windshield and flip the base lever down (B) to the locked position. See diagram below.
- Step 2.** Adjust the angle of the pedestal arm by tightening the angle adjustment knob (C) at the base to the desired angle.

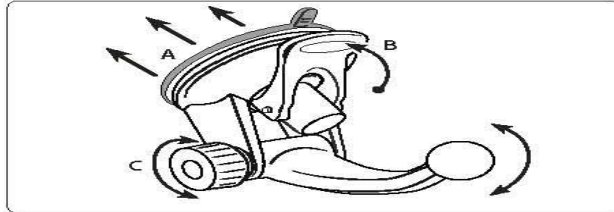

Swivel Ball Head Assembly Attachment

- Step 1.** Slip the tightening ring (D) over the pedestal ball. Snap the dual-T head adapter plate (E) on to the pedestal ball (F). Screw the tightening ring over the adapter plate until securely holding the plate. Adjust the angle as needed.

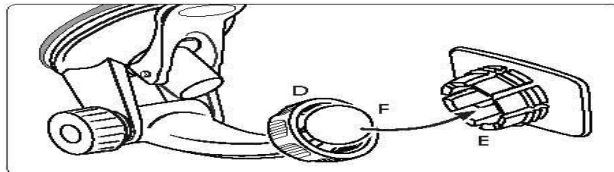

Attach Cradle or Device to Pedestal

- Step 1.** To attach your cradle or device (not included, sold separately) to the dual T-head, insert the dual T-tabs (G) into the dual T-slots (H) on the back of the cradle or device.

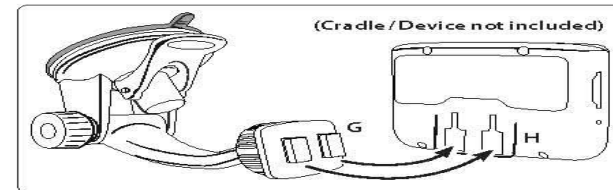

Attaching a Garmin Device to Pedestal

- Step 1.** Do not attach the swivel ball head assembly. Attach your Garmin device (not included, sold separately) to the ball head by firmly inserting the ball head (I) into the cavity (J) in the back of the device.

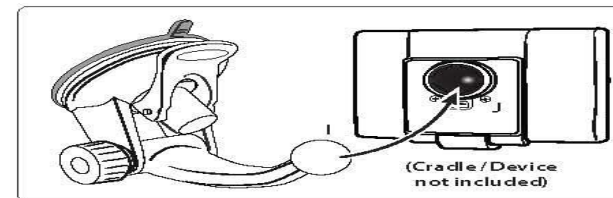

All brand names and product names are trademarks or registered trademarks of their respective owners.



Safety Precautions

Follow all manufacturer safety guidelines for operating your device. Failure to practice safe usage of GPS device while driving may result in damage, injury, or death.

Arkon is not responsible for any damages caused to your car, your device, or yourself due to the installation or use of this pedestal mount.

ARKON
RESOURCES INC.

The Mobile Mounting Specialists™

Consumer Hotline:

USA (800) 841-0884

INT'L (626) 254-9005

Monday - Friday 9am - 5pm, PST

www.arkon.com

Arcadia, CA 91006 USA

Designed in USA | Made in China and Taiwan

© Copyright 2009 Arkon Resources, Inc.

